

Viega ProPress® Ball Valve - Zero Lead* Model 2971.3 ZL

Description

The Zero Lead bronze ball valve is equipped with a full port, Zero Lead bronze body. The ball valve features EPDM sealing elements, EPDM stem seals and Viega's Smart Connect® feature for easy identification of unpressed connections during pressure testing.

Features

- 316 stainless steel ball
- 316 stainless steel blowout-proof stem
- Lockable metal handle
- Reinforced PTFE seats
- Smart Connect feature

Ratings

- 250 CWP
- Temperature Range: 0°F - 250°F
- Max. Operating Pressure: 250 psi

Approvals

- Conforms to MSS SP-110
- NSF - UP Code
- NSF 61 Annex G
- ASME A112.4.14
- Listed by NSF to Commercial Hot

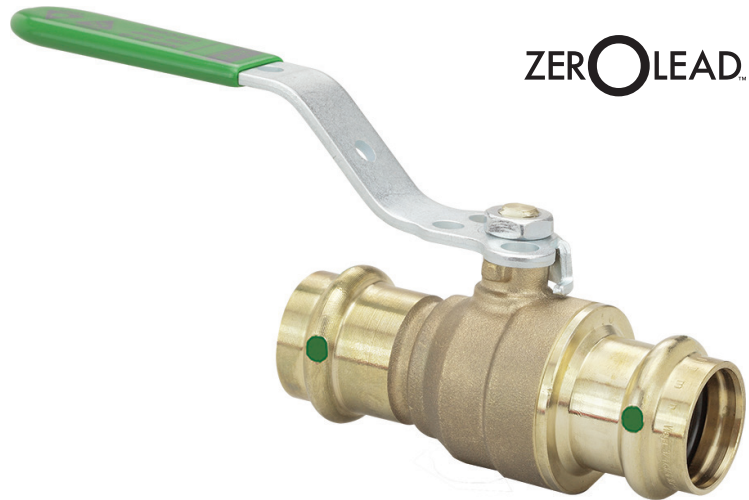

ZERO LEAD™

| Component | Material |
|-----------------|-------------------------|
| Body | Zero Lead Bronze C87700 |
| Ball | 316 Stainless Steel |
| Seat | Reinforced PTFE |
| Stem | 316 Stainless Steel |
| Stem Seals | EPDM |
| Nut | Zinc plated Steel |
| Handle | Zinc plated Steel |
| Handle Cover | Polyvinyl |
| Sealing Element | EPDM |

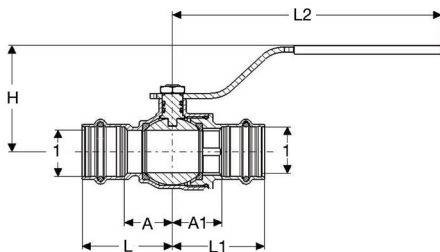

| Part No. | Size (1) | A (in) | A1 (in) | L (in) | L1 (in) | L2 (in) | H (in) |
|----------|----------|--------|---------|--------|---------|---------|--------|
| 79923 | ½" | 0.75 | 0.75 | 1.57 | 1.57 | 4.57 | 1.97 |
| 79928 | ¾" | 0.85 | 0.87 | 1.75 | 1.77 | 4.57 | 2.09 |
| 79933 | 1" | 1.02 | 1.06 | 1.93 | 1.96 | 5.75 | 2.46 |
| 79938 | 1¼" | 1.14 | 1.12 | 2.17 | 2.15 | 5.75 | 2.67 |

*Zero Lead identifies Viega® products meeting the lead free requirements of NSF 61-G through testing under NSF/ANSI 372 (0.25% or less maximum weighted average lead content).

This document subject to updates. For the most current Viega technical literature please visit www.viega.us.
Click Services -> Click Electronic Literature Downloads -> Select Product Line -> Select Desired Document

Viega LLC, 100 N. Broadway, 6th Floor • Wichita, KS 67202 • Ph: 800-976-9819 • Fax: 316-425-7618