

Part No: P504-623

DWV

Wye

Desc: 10X10X3 PVC DWV CMB WYE&1/8 BEND RD 2-PC

MSRP: 886.79

Part Code: 052

Weight(lbs): 31.705

Weight(kg): 14.381

Weight(gm): 14381

Size: 10"X3"

Color: WHITE

Material: PVC

Type Red Comb Wye & 1/8 Bend (Two Piece)

Connection All Hub

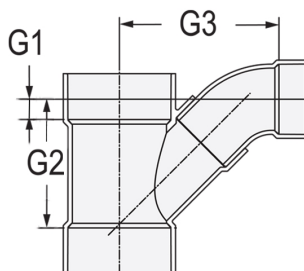

G1 = 1- 1/4

G2 = 12-1/16

G3 = 14-3/32

Injection Molded Dimension References:

G = (LAYING LENGTH) intersection of center lines to bottom of socket/thread; 90° elbows, tees, crosses; ± 1/32 inch.

H = Intersection of center lines to face of fitting; 90° elbows tees, crosses; ± 1/32 inch.

J = Intersection of center lines to bottom of socket/thread; 45° elbows; ± 1/32 inch

L = Overall length of fittings; ± 1/16 inch.

M = Outside diameter of socket/thread hub; ± 1/16 inch.

N = Socket bottom to socket bottom; couplings; ± 1/16 inch.

W = Height of cap; ± 1/16 inch

Typical Bushing Dimension References

