

**Part No:** 869SV-420SR

**Schedule 80 PVC & CPVC**

**Clamp-On Saddle**

**Desc:** 4X2 PVC CLAMP SADDLE D/O SRFPT FKM SS

**MSRP:** 211.14

**Part Code:** 086

**Weight(lbs):** 2.088

**Weight(kg):** 0.947

**Weight(gm):** 947

**Size:** 4"X2"

**Color:** GRAY

**Material:** PVC

**Connection** Double SR Fipt

**Type** Clamp Saddle

**Hardware** SS

**O-Ring** FKM

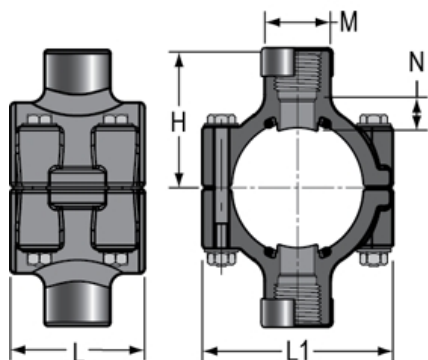

**L1** = 5-13/16

**M** = 3-1/32

**N** = 1

**Bolt** = 8  
**Torque**  
**FT./LBS.**

**Hole Size** = 2-1/4

**No of**  
**Bolts** = 4

**H** = 4-1/4

**L** = 4- 1/8

## Injection Molded Dimension References:

**G** = (LAYING LENGTH) intersection of center lines to bottom of socket/thread; 90° elbows, tees, crosses; ± 1/32 inch.

**H** = Intersection of center lines to face of fitting; 90° elbows tees, crosses; ± 1/32 inch.

**J** = Intersection of center lines to bottom of socket/thread; 45° elbows; ± 1/32 inch

**L** = Overall length of fittings; ± 1/16 inch.

**M** = Outside diameter of socket/thread hub; ± 1/16 inch.

**N** = Socket bottom to socket bottom; couplings; ± 1/16 inch.

**W** = Height of cap; ± 1/16 inch

## Typical Molded Dimension References

