

**Part No:** 847-050CF

**Fabricated Fittings**

**Caps/Plugs**

**Desc:** 5 CPVC DOME CAP SCH80 FAB

**MSRP:** 343.43

**Part Code:** 097

**Weight(lbs):** 1.982

**Weight(kg):** 0.899

**Weight(gm):** 899

**Size:** 5

**Color:** GRAY

**Material:** CPVC

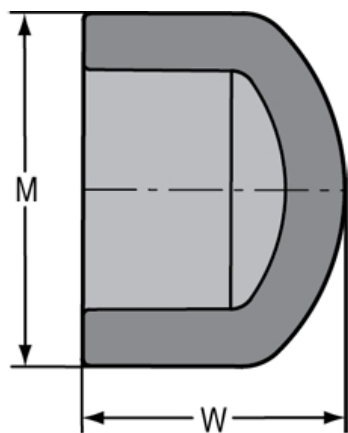

**M** = 6-1/2

**W** = 4-7/16

**Schedule** Schedule 80

**Connection** Socket (Cap)

## Fabricated Dimension References:

- G** = (LAYING LENGTH) intersection of center lines to bottom of socket/thread; 90° elbows, tees, crosses;  $\pm 1/4$  & larger  $\pm 1/2$  inch.
- H** = Intersection of center lines to face of fitting; 90° elbows, tees, crosses;  $\pm 1/4$  inch.; wyes  $\pm 1/2$  inch; 14" & larger inch.
- J** = Intersection of center lines to bottom of socket/thread; 45° elbows;  $\pm 1/4$  inch; 14" & larger  $\pm 1/2$  inch.
- L** = Overall length of fittings;  $\pm 1/2$  inch; wyes  $\pm 1$  inch; 14" & larger  $\pm 1$  inch.
- M** = Outside diameter of socket/thread hub;  $\pm 1/4$  inch.
- N** = Socket bottom to socket bottom; couplings;  $\pm 1/2$  inch.
- W** = Height of cap;  $\pm 1/4$  inch.

## Typical Fabricated Dimension References

