

Part No: 8172V-025

Schedule 80 PVC & CPVC

Tank Adapter

Desc: 2-1/2 PVC TANK ADAPT FPTXFPT FKM GASKET

MSRP: 399.81

Part Code: 100

Weight(lbs): 1.969

Weight(kg): 0.893

Weight(gm): 893

Size: 2-1/2"

Color: GRAY

Material: PVC

Connection Fipt x Fipt (New Style)

Gasket FKM

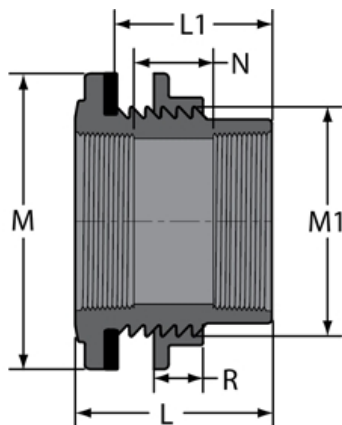

L = 4-27/32

L1 = 3-29/32

M = 5- 1/4

M1 = 3-13/16

N = 2-7/32

R = 1

**Min Hole
Size** = 3-7/8

Injection Molded Dimension References:

G = (LAYING LENGTH) intersection of center lines to bottom of socket/thread; 90° elbows, tees, crosses; ± 1/32 inch.

H = Intersection of center lines to face of fitting; 90° elbows tees, crosses; ± 1/32 inch.

J = Intersection of center lines to bottom of socket/thread; 45° elbows; ± 1/32 inch

L = Overall length of fittings; ± 1/16 inch.

M = Outside diameter of socket/thread hub; ± 1/16 inch.

N = Socket bottom to socket bottom; couplings; ± 1/16 inch.

W = Height of cap; ± 1/16 inch

Typical Molded Dimension References

