

**Part No:** 2223-005

**Valves**

**Ball Check Valve**

**Desc:** 1/2 PVC TU BALL CHECK VALVE FLANGED EPDM

**MSRP:** 146.03

**Part Code:** 220

**Weight(lbs):** 0.999

**Weight(kg):** 0.453

**Weight(gm):** 453

**Size:** 1/2"

**Color:** GRAY

**Material:** PVC

**Connection** Flanged (Regular Style)

**O-Ring** EPDM

**Pressure Rating** 150 psi @ 73° F

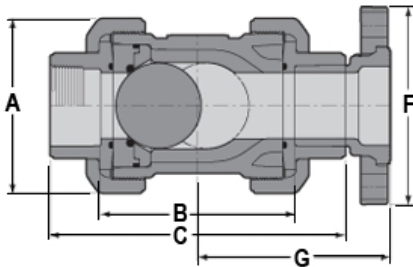

A = 2- 9/16

B = 3- 5/16

C = 5- 1/8

F = 3- 1/2

G = 3- 7/16

Cv = 18

**Values**

## Injection Molded Dimension References:

**G** = (LAYING LENGTH) intersection of center lines to bottom of socket/thread; 90° elbows, tees, crosses; ± 1/32 inch.

**H** = Intersection of center lines to face of fitting; 90° elbows tees, crosses; ± 1/32 inch.

**J** = Intersection of center lines to bottom of socket/thread; 45° elbows; ± 1/32 inch

**L** = Overall length of fittings; ± 1/16 inch.

**M** = Outside diameter of socket/thread hub; ± 1/16 inch.

**N** = Socket bottom to socket bottom; couplings; ± 1/16 inch.

**W** = Height of cap; ± 1/16 inch

## Typical Molded Dimension References

