

**Part No:** 2222-060

**Valves**

**Ball Check Valve**

**Desc:** 6 PVC TU BALL CHECK VLV SOC EPDM VENTURI

**MSRP:** 2066.22

**Part Code:** 221

**Weight(lbs):** 21.927

**Weight(kg):** 9.946

**Weight(gm):** 9946

**Size:** 6"

**Color:** GRAY

**Material:** PVC

**Connection** Socket (Regular Style)

**O-Ring** EPDM

**Pressure Rating** 150 psi @ 73° F

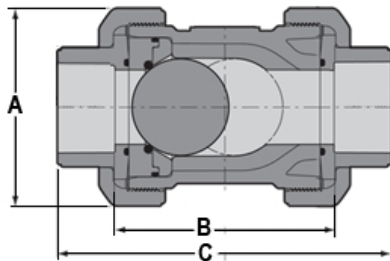

**A** = 8-15/16

**B** = 19- 5/8

**C** = 26- 1/16

## Injection Molded Dimension References:

**G** = (LAYING LENGTH) intersection of center lines to bottom of socket/thread; 90° elbows, tees, crosses; ± 1/32 inch.

**H** = Intersection of center lines to face of fitting; 90° elbows tees, crosses; ± 1/32 inch.

**J** = Intersection of center lines to bottom of socket/thread; 45° elbows; ± 1/32 inch

**L** = Overall length of fittings; ± 1/16 inch.

**M** = Outside diameter of socket/thread hub; ± 1/16 inch.

**N** = Socket bottom to socket bottom; couplings; ± 1/16 inch.

**W** = Height of cap; ± 1/16 inch

## Typical Molded Dimension References

