

FIG. 460

Stainless Steel End Caps

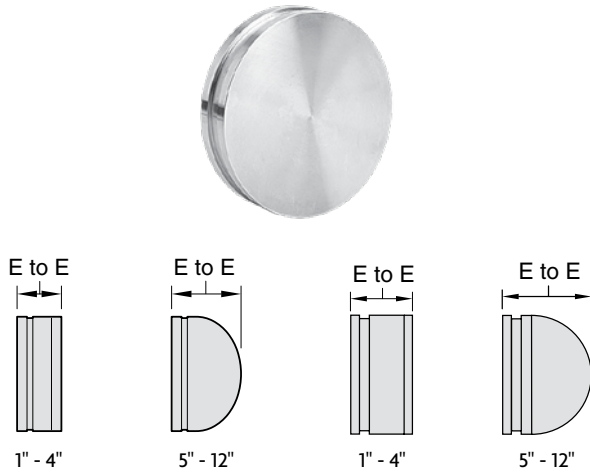

Figure 460A
Full-Flow End Cap

Figure 460
Fabricated End Cap

FIGURE 460 STAINLESS STEEL END CAPS			
Nominal Size	O.D.	End to End	Approx. Wt. Ea.
In./DN(mm)	In./mm	In./mm	Lbs./Kg
1	1.315	1.08	0.2
25	33.4	27.5	0.09
1 1/4	1.660	1.08	0.4
32	42.4	27.5	0.09
1 1/2	1.900	1.08	0.5
40	48.3	27.5	0.09
2	2.375	1.08	0.7
50	60.3	27.5	0.09
2 1/2	2.875	1.08	1.0
65	73.0	27.5	0.45
76.1mm	3.000	2.36	3.1
65	76.1	60.0	1.41
3	3.500	1.08	2.0
80	88.9	27.5	0.91
4	4.500	1.13	3.1
100	114.3	28.7	1.41
5	5.563	3.00	1.5
125 *	141.3	76.2	0.68
6	6.625	3.50	1.5
150 *	168.3	88.9	0.68
8	8.625	4.00	3.1
200 *	219.1	101.6	1.41
10	10.750	5.00	6.0
250 *	273.0	127.0	2.72
12	12.750	6.00	7.8
300 *	323.9	152.4	3.54

* Dished Cap

Notes:

For information on larger sizes, contact an Anvil Sales Representative.
Schedule 40 fittings available upon request, contact an Anvil Sales Representative.
See next page for Stainless Steel Fitting Specifications.

FIG. 441

Stainless Steel Flange Adapters (ANSI Class 150#)

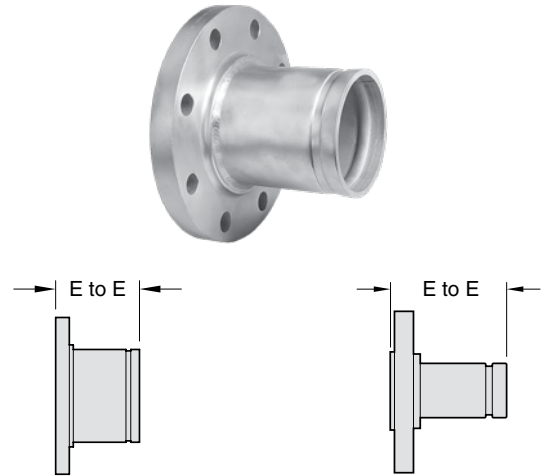

Figure 441A
Full-Flow Flange Adapter

Figure 441
Fabricated Flange Adapter

FIGURE 441 STAINLESS STEEL FLANGE ADAPTER (ANSI CLASS 150#)				
Nominal Size	O.D.	End to End	Mating Flange Bolt	Approx. Wt. Ea.
In./DN(mm)	In./mm	In./mm	Qty.	Lbs./Kg
1	1.315	3.00	4	2.5
25	33.4	76.2	4	1.1
1 1/4	1.660	4.00	4	3.8
32	42.4	101.6	4	1.7
1 1/2	1.900	4.00	4	4.1
40	48.3	101.6	4	1.9
2	2.375	4.00	4	6.0
50	60.3	101.6	4	2.7
2 1/2	2.875	4.00	4	9.2
65	73.0	101.6	4	4.2
3	3.500	4.00	4	10.4
80	88.9	101.6	4	4.7
3 1/2	4.000	4.00	4	14.0
90	101.6	101.6	4	6.4
4	4.500	6.00	8	19.1
100	114.3	152.4	8	8.7
5	5.563	6.00	8	23.0
125	141.3	152.4	8	10.4
6	6.625	6.00	8	28.1
150	168.3	152.4	8	12.7
8	8.625	6.00	8	43.7
200	219.1	152.4	8	19.8
10	10.750	8.00	12	68.2
250	273.0	203.2	12	30.9
12	12.750	8.00	12	96.1
300	323.9	203.2	12	43.6



For Fire Protection pressure rating, listing, and approval information, contact your Anvil Sales Representative.

PROJECT INFORMATION

APPROVAL STAMP

Project:	<input type="checkbox"/> Approved
Address:	<input type="checkbox"/> Approved as noted
Contractor:	<input type="checkbox"/> Not approved
Engineer:	Remarks:
Submittal Date:	
Notes 1:	
Notes 2:	

STAINLESS STEEL GROOVED FITTINGS

Gruvlok Stainless Steel, Full-Flow Grooved fittings are made of lightweight, corrosion-resistant Type 304 and 316 stainless steel. The assortment of available fittings provides economical and efficient methods to change direction in, add outlets to, reduce, or cap piping systems.

Fittings are available in full-flow and fabricated versions in 304 and 316L S.S. Fabricated fittings are available with Schedule 10 or Schedule 40 wall thickness.

MAXIMUM WORKING PRESSURE

See specific data sheet for rating of coupling in use.

For local country potable water approvals, contact an Anvil Sales Representative.



For Fire Protection pressure rating, listing, and approval information, contact your Anvil Sales Representative.

MATERIAL SPECIFICATIONS

FABRICATED FITTINGS:

304/316L stainless steel conforming to ASTM A 312, Schedule 10 and Schedule 40

FULL FLOW FITTINGS:

304/316L stainless steel conforming to ASTM A 403 WPW or A 403 CR