

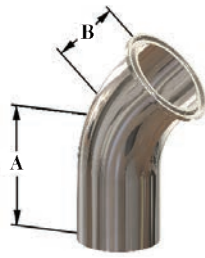

## High Purity BioPharm Fittings

### 45° Clamp x Weld Elbows - T2KM



BPE Table DT-4.1.1-5

Size	Dimensions		PL finish - SF1		PM finish - SF4	
	A	B	Part #	Price/E	Part #	Price/E
1/2"	2.250"	1.000"	<b>T2KM-050PL</b>	<b>\$86.15</b>	<b>T2KM-050PM</b>	<b>\$104.80</b>
3/4"	2.250"	1.000"	<b>T2KM-075PL</b>	<b>86.15</b>	<b>T2KM-075PM</b>	<b>104.80</b>
1"	2.250"	1.125"	<b>T2KM-100PL</b>	<b>80.75</b>	<b>T2KM-100PM</b>	<b>102.15</b>
1 1/2"	2.500"	1.438"	<b>T2KM-150PL</b>	<b>83.45</b>	<b>T2KM-150PM</b>	<b>103.40</b>
2"	3.000"	1.750"	<b>T2KM-200PL</b>	<b>95.25</b>	<b>T2KM-200PM</b>	<b>130.25</b>
2 1/2"	3.375"	2.063"	<b>T2KM-250PL</b>	<b>121.35</b>	<b>T2KM-250PM</b>	<b>167.05</b>
3"	3.625"	2.380"	<b>T2KM-300PL</b>	<b>162.05</b>	<b>T2KM-300PM</b>	<b>216.50</b>
4"	4.500"	3.125"	<b>T2KM-400PL</b>	<b>219.00</b>	<b>T2KM-400PM</b>	<b>289.05</b>

### 45° Clamp x Clamp Elbows - T2KMP



BPE Table DT-4.1.1-6

Size	Dimension A	PL finish - SF1		PM finish - SF4	
		Part #	Price/E	Part #	Price/E
1/2"	1.000"	<b>T2KMP-050PL</b>	<b>\$104.30</b>	<b>T2KMP-050PM</b>	<b>\$123.80</b>
3/4"	1.000"	<b>T2KMP-075PL</b>	<b>104.30</b>	<b>T2KMP-075PM</b>	<b>123.80</b>
1"	1.125"	<b>T2KMP-100PL</b>	<b>90.90</b>	<b>T2KMP-100PM</b>	<b>111.65</b>
1 1/2"	1.438"	<b>T2KMP-150PL</b>	<b>94.55</b>	<b>T2KMP-150PM</b>	<b>112.90</b>
2"	1.750"	<b>T2KMP-200PL</b>	<b>108.30</b>	<b>T2KMP-200PM</b>	<b>145.10</b>
2 1/2"	2.063"	<b>T2KMP-250PL</b>	<b>167.10</b>	<b>T2KMP-250PM</b>	<b>200.75</b>
3"	2.380"	<b>T2KMP-300PL</b>	<b>211.40</b>	<b>T2KMP-300PM</b>	<b>248.25</b>
4"	3.125"	<b>T2KMP-400PL</b>	<b>474.70</b>	<b>T2KMP-400PM</b>	<b>534.60</b>

### Weld x Weld x Weld Tees - T7WWW

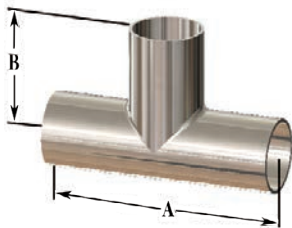

BPE Table DT-4.1.2-1

Size	Dimensions		PL finish - SF1		PM finish - SF4	
	A	B	Part #	Price/E	Part #	Price/E
1/2"	3.750"	1.875"	<b>T7WWW-050PL</b>	<b>\$78.40</b>	<b>T7WWW-050PM</b>	<b>\$110.15</b>
3/4"	4.000"	2.000"	<b>T7WWW-075PL</b>	<b>76.90</b>	<b>T7WWW-075PM</b>	<b>110.15</b>
1"	4.250"	2.125"	<b>T7WWW-100PL</b>	<b>58.85</b>	<b>T7WWW-100PM</b>	<b>100.65</b>
1 1/2"	4.750"	2.375"	<b>T7WWW-150PL</b>	<b>71.20</b>	<b>T7WWW-150PM</b>	<b>112.45</b>
2"	5.750"	2.875"	<b>T7WWW-200PL</b>	<b>87.85</b>	<b>T7WWW-200PM</b>	<b>136.70</b>
2 1/2"	6.250"	3.125"	<b>T7WWW-250PL</b>	<b>121.35</b>	<b>T7WWW-250PM</b>	<b>164.20</b>
3"	6.750"	3.375"	<b>T7WWW-300PL</b>	<b>168.40</b>	<b>T7WWW-300PM</b>	<b>216.50</b>
4"	8.250"	4.125"	<b>T7WWW-400PL</b>	<b>244.30</b>	<b>T7WWW-400PM</b>	<b>310.80</b>

### Weld x Weld x Weld Reducing Tees - T7RWWW

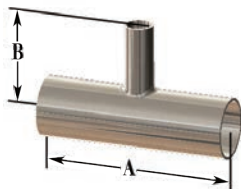

BPE Table DT-4.1.2-6

Size	Dimensions		PL finish - SF1		PM finish - SF4	
	A	B	Part #	Price/E	Part #	Price/E
3/4" x 1/2"	4.000"	2.000"	<b>T7RWWW-075050PL</b>	<b>\$118.65</b>	<b>T7RWWW-075050PM</b>	<b>\$142.65</b>
1" x 1/2"	4.250"	2.125"	<b>T7RWWW-100050PL</b>	<b>122.40</b>	<b>T7RWWW-100050PM</b>	<b>147.95</b>
1" x 3/4"	4.250"	2.125"	<b>T7RWWW-100075PL</b>	<b>122.40</b>	<b>T7RWWW-100075PM</b>	<b>147.95</b>
1 1/2" x 1/2"	4.750"	2.375"	<b>T7RWWW-150050PL</b>	<b>128.70</b>	<b>T7RWWW-150050PM</b>	<b>172.85</b>
1 1/2" x 3/4"	4.750"	2.375"	<b>T7RWWW-150075PL</b>	<b>128.70</b>	<b>T7RWWW-150075PM</b>	<b>157.15</b>
1 1/2" x 1"	4.750"	2.375"	<b>T7RWWW-150100PL</b>	<b>128.70</b>	<b>T7RWWW-150100PM</b>	<b>157.15</b>
2" x 1/2"	5.750"	2.625"	<b>T7RWWW-200050PL</b>	<b>166.65</b>	<b>T7RWWW-200050PM</b>	<b>198.10</b>
2" x 3/4"	5.750"	2.625"	<b>T7RWWW-200075PL</b>	<b>166.65</b>	<b>T7RWWW-200075PM</b>	<b>198.10</b>
2" x 1"	5.750"	2.625"	<b>T7RWWW-200100PL</b>	<b>166.65</b>	<b>T7RWWW-200100PM</b>	<b>198.10</b>
2" x 1 1/2"	5.750"	2.625"	<b>T7RWWW-200150PL</b>	<b>166.65</b>	<b>T7RWWW-200150PM</b>	<b>198.10</b>

PL Finish – SF1

OD = 32R<sub>a</sub> Mechanically Polished

ID = 20R<sub>a</sub> Mechanically Polished

PM Finish – SF4

OD = 32R<sub>a</sub> Mechanically Polished

ID = 15R<sub>a</sub> Mechanically Polished and Electropolished