

Non-Encapsulated 2-way 3 Piece Stainless Steel Ball Valves

Sanitary Fittings



Materials:

- body, ends and ball: CF8M stainless
- seats: 15% glass reinforced PTFE

Features:

- blow-out proof stem
- live-loaded stem packing
- ID polish is $R_a 32$
- lockable handle

Specifications:

- maximum pressure rating: ½" - 2" **1000 PSI WOG**, 2½" - 4" **800 PSI WOG**
- maximum temperature: **300°F (149°C)**
- repair kits available

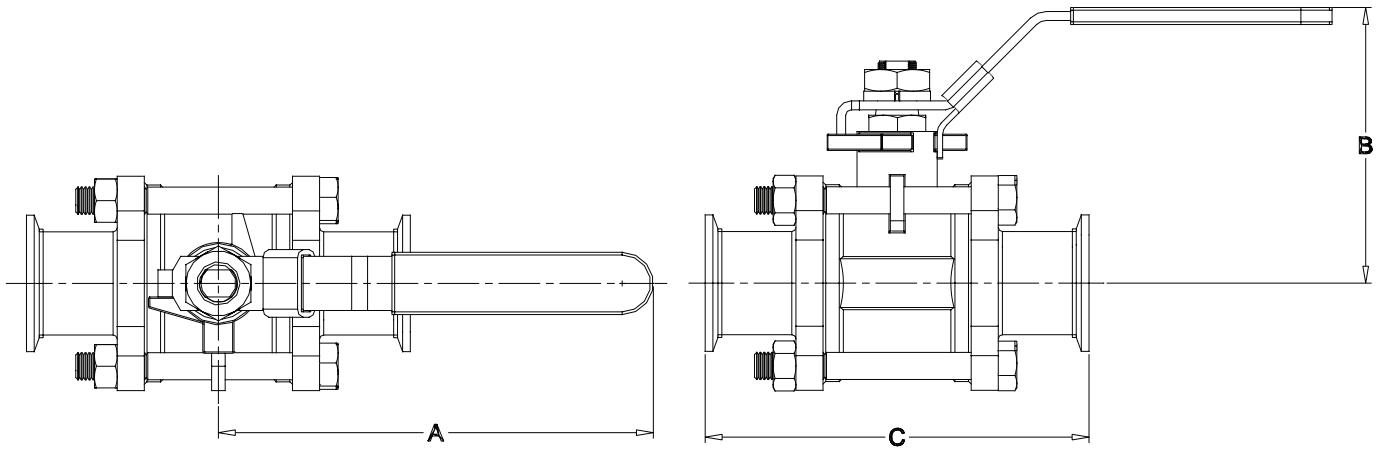

Size	Dimensions			316 Stainless Steel Part #
	A	B	C	
½"	4.1"	2.3"	4.6"	BV2GG-050CC-A
¾"	4.1"	2.5"	4.7"	BV2GG-075CC-A
1"	5.0"	2.8"	4.9"	BV2GG-100CC-A
1½"	6.1"	3.5"	5.6"	BV2GG-150CC-A
2"	7.6"	3.9"	6.4"	BV2GG-200CC-A
2½"	7.6"	4.4"	7.8"	BV2GG-250CC-A
3"	10.9"	4.9"	9.0"	BV2GG-300CC-A
4"	13.2"	6.6"	9.6"	BV2GG-400CC-A

Dimensions are approximate. Engineering dimensions are available upon request. Specifications are subject to change without notice.