

## Clamp Fittings - Adapters

## Rubber Hose - 14MPHR

Tube OD	Hose Size	Dimensions		304 Stainless Steel Part #	316L Stainless Steel Part #
		A	B		
½"	¼"	1.500"	.290"	---	<b>14MPHR-R5025</b>
	½"	1.500"	.540"	---	<b>14MPHR-R50</b>
	¾"	1.500"	.790"	---	<b>14MPHR-R5075</b>
¾"	¼"	1.500"	.290"	---	<b>14MPHR-R7525</b>
	⅜"	1.500"	.415"	---	<b>14MPHR-R75375</b>
	½"	1.500"	.540"	---	<b>14MPHR-R7550</b>
	¾"	1.500"	.790"	---	<b>14MPHR-R75</b>
1"	⅜"	1.500"	.415"	---	<b>14MPHR-R100375</b>
	½"	1.500"	.540"	---	<b>14MPHR-R10050</b>
	¾"	1.688"	.790"	<b>14MPHR-G10075</b>	<b>14MPHR-R10075</b>
	1"	1.688"	1.040"	<b>14MPHR-G100</b>	<b>14MPHR-R100</b>
1½"	½"	1.500"	.540"	<b>14MPHR-G15050</b>	<b>14MPHR-R15050</b>
	⅝"	1.500"	.665"	---	<b>14MPHR-R150625</b>
	¾"	1.500"	.790"	<b>14MPHR-G15075</b>	<b>14MPHR-R15075</b>
	1"	1.687"	1.040"	<b>14MPHR-G150100</b>	<b>14MPHR-R150100</b>
	1½"	1.687"	1.540"	<b>14MPHR-G150</b>	<b>14MPHR-R150</b>
2"	1½"	2.312"	1.540"	<b>14MPHR-G200150</b>	<b>14MPHR-R200150</b>
	2"	2.312"	2.040"	<b>14MPHR-G200</b>	<b>14MPHR-R200</b>
2½"	2½"	2.344"	2.540"	<b>14MPHR-G250</b>	<b>14MPHR-R250</b>
3"	3"	3.094"	3.040"	<b>14MPHR-G300</b>	<b>14MPHR-R300</b>
4"	4"	3.406"	4.040"	<b>14MPHR-G400</b>	<b>14MPHR-R400</b>
6"	6"	3.406"	6.040"	<b>14MPHR-G600</b>	<b>14MPHR-R600</b>

Sanitary Fittings

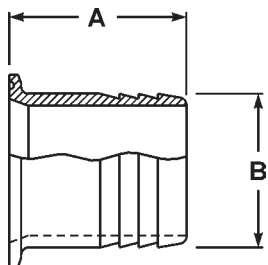

## Brewery Hose Barb - 14MPHRL

## Feature:

- suitable for use with band clamps

Tube OD	Dimensions		304 Stainless Steel Part #
	A	B	
1"	3.500"	1.045"	<b>14MPHRL100</b>
1½"	5.000"	1.545"	<b>14MPHRL150</b>
2"	5.000"	2.045"	<b>14MPHRL200</b>
2½"	5.500"	2.545"	<b>14MPHRL250</b>
3"	5.500"	3.045"	<b>14MPHRL300</b>
4"	5.500"	4.045"	<b>14MPHRL400</b>

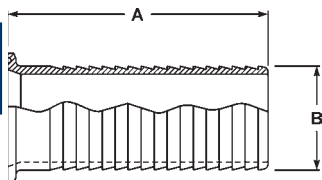

Use of PVC tubing requires special installation techniques to prevent leakage. All assembly work must be done with heated tube. Cold durometer is 90 as opposed to rubber hose at 65 to 70 durometer. Banding buckles must be at 180° from one another.

