

Regulator R16

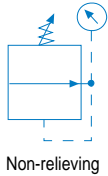
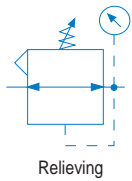

R16-02-000

Features

- Non-rising adjustment knob with friction lock knob.
- Standard with two full flow 1/4" NPT/BSPT-Rc gauge ports.
- Panel mount nut.
- High flow capacity.
- Balanced valve design for excellent regulation characteristics.

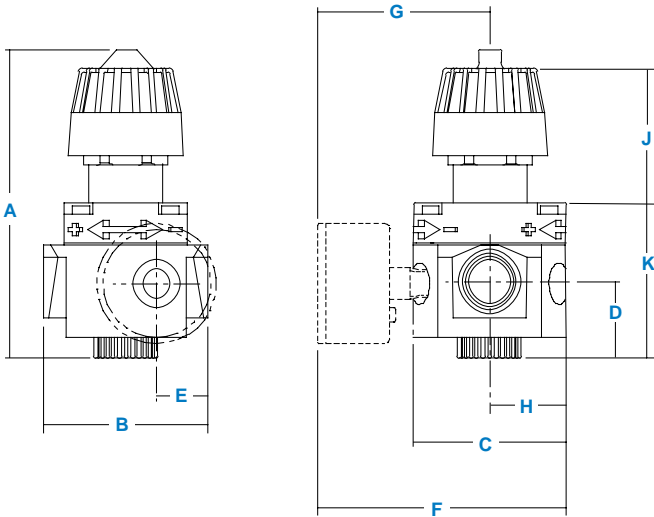

NOTE: 1.31" Dia. (33.3 mm) hole required for panel nut mounting

Specifications

Flow Capacity*	1/4	71.5 scfm (33,7 dm ³ /s)
	3/8	80.5 scfm (38,0 dm ³ /s)
	1/2	88.0 scfm (41,5 dm ³ /s)

Maximum Operating Temperature	175°F (79°C)
-------------------------------	--------------

Maximum Supply Pressure	300 psig (21 bar)
-------------------------	-------------------

Adjusting Range Pressure	0-50 psig (0-3,4 bar)
	0-125 psig (0-8,5 bar)
	0-250 psig (0-17,1 bar)

Port Size	NPT/BSPP-G	1/4, 3/8, 1/2
-----------	------------	---------------

Gauge Port (2 ea.)	NPT/BSPT-Rc	1/4
--------------------	-------------	-----

Weight	lb. (kg)	1.7 (0,77)
--------	----------	------------

*Inlet pressure 100 psig (7 bar). Secondary pressure 90 psig (6 bar).

Materials of Construction

Body	Zinc
Bonnet	PBT
Diaphragm	Nitrile/Zinc
Valve Assembly	Brass/Nitrile/Acetal
Springs	Steel
Seals	Nitrile
Panel Nut	Acetal

Dimensions

Models	Inches mm	A	B	C	D	E	F	G	H	J	K
Standard Unit R16-XX-000		5.2 132	3.0 76	2.6 66	1.2 30.5	1.02 25.9	— —	— —	1.3 33	2.56 65	2.62 65
With Gauge R16-XX-G00		5.2 132	3.0 76	2.6 66	1.2 30.5	1.02 25.9	4.3 109	2.80 71	1.3 33	2.56 65	2.62 65

Replacement Kits

Diaphragm Assembly, Non-relieving.....	RRP-96-216
Diaphragm Assembly, Self-relieving.....	RRP-96-213
Knob, Adjusting (Series A).....	RRP-95-023
Knob, Adjusting (prior to Series A).....	RRP-95-007
Spring, Regulating, 0-50 psig (0-3,4 bar).....	RRP-95-222
Spring, Regulating, 0-125 psig (0-8,6 bar).....	RRP-95-224
Spring, Regulating, 0-250 psig (0-17,2 bar).....	RRP-95-218
Valve Assembly (Series A)—Valve, Valve Spring, Bottom Plug O-ring.....	RRP-96-215

Accessories

Wall Mounting Bracket, Gauge Port Adapter, 1/4 NPT.....	RRP-95-590
Wall Mounting Bracket, L-Type—Heavy Duty.....	RPA-95-090
Wall Mounting Bracket, L-Type—Standard.....	GPA-95-012
Wall Mounting Bracket, L-Type with Plastic Panel Mount Nut.....	GPA-95-011
Gauge, Pressure, 0-60 psig (0-4 bar) 2 Dial Face, 1/4 NPT, CBM.....	RRP-95-230
Gauge, Pressure, 0-160 psig (0-11 bar) 2 Dial Face, 1/4 NPT, CBM.....	GRP-95-229
Gauge, Pressure, 0-300 psig (0-20 bar) 2 Dial Face, 1/4 NPT, CBM.....	RRP-95-231
Panel Mount Nut, Plastic.....	GPA-95-032
Tamper Resistant Kit, Ring Style.....	RPA-95-006

For best performance, regulated pressure should always be set by increasing the pressure up to the desired setting.

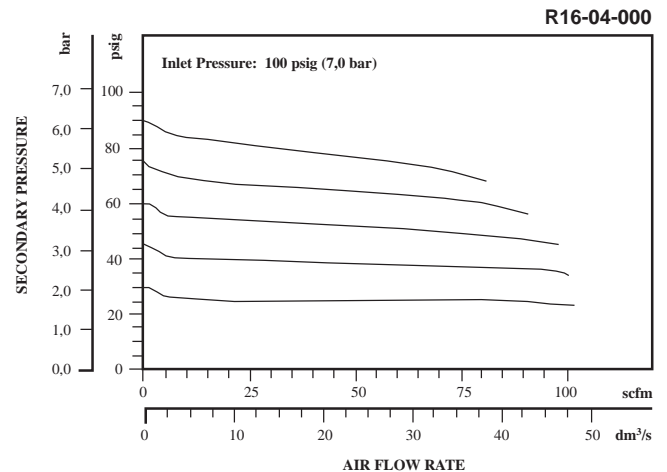
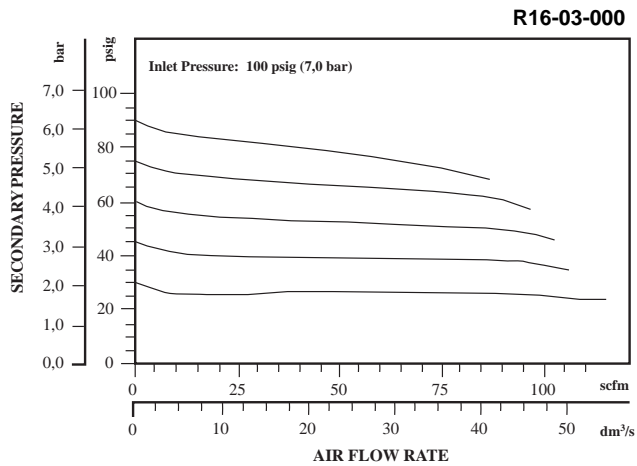
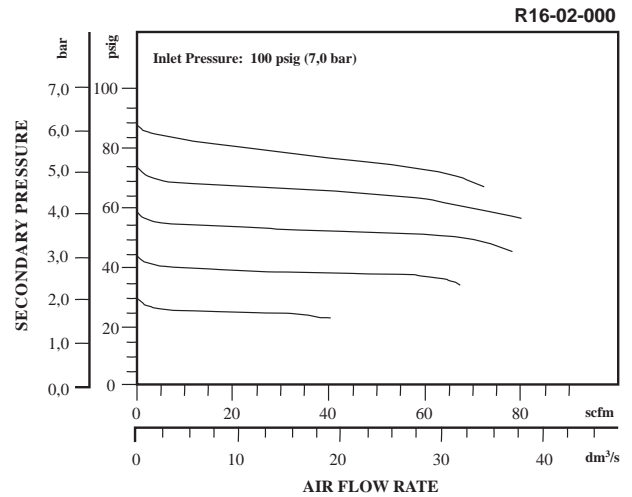

Ordering Information

Model Type	Port Size	Without Gauge	Without Gauge	Without Gauge	With Gauge	With Gauge	With Gauge
		5-125 psig (0,4-8,5 bar)	10-250 psig (0,7-17 bar)	3-60 psig (0,2-4,1 bar)	5-125 psig (0,4-8,5 bar)	10-250 psig (0,7-17 bar)	3-60 psig (0,2-4,1 bar)
Relieving	1/4	R16-02-000	R16-02-H00	R16-02-L00	R16-02-G00	R16-02-GH0	R16-02-GL0
	3/8	R16-03-000	R16-03-H00	R16-03-L00	R16-03-G00	R16-03-GH0	R16-03-GL0
	1/2	R16-04-000	R16-04-H00	R16-04-L00	R16-04-G00	R16-04-GH0	R16-04-GL0
Non-relieving	1/4	R16-02-N00	R16-02-HN0	R16-02-LN0	R16-02-GN0	R16-02-GHN	R16-02-GLN
	3/8	R16-03-N00	R16-03-HN0	R16-03-LN0	R16-03-GN0	R16-03-GHN	R16-03-GLN
	1/2	R16-04-N00	R16-04-HN0	R16-04-LN0	R16-04-GN0	R16-04-GHN	R16-04-GLN

Options - To order an option supplied with the unit model, add the appropriate coded suffix letter in position 6, 7, 8 of the model number. For additional information on accessories and repair kits refer to pages 326 through 334.